

FOR SALE OR LEASE | DEVELOPMENT OPPORTUNITY

8521 Seneca Turnpike, New Hartford, New York

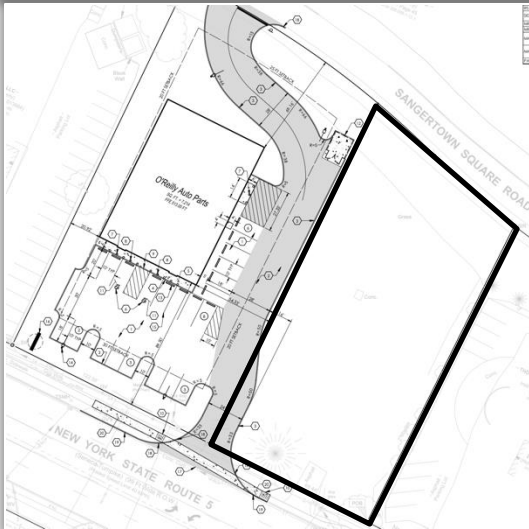

COMMERCIAL REAL ESTATE SALES | LEASING | CONSULTING | DEVELOPMENT | MANAGEMENT



PROPERTY HIGHLIGHTS

Parcel Size: .62 ± acres

Zoning: General Commercial

Tax Parcel ID: 328.12-1-67 & 328.12-1-64

Sale Price: \$500,000.00

Lease Price: \$65,000.00 Annually NNN

Comments: .62 ± acre parcel located next to proposed O'Reilly Auto Parts. Situated along major retail corridor with high traffic and visibility. AADT 20,076 ±

READY TO MAKE A DEAL? CLICK HERE NOW!



Dominic Pavia, President
Licensed Real Estate Broker
315.736.1555 x300 Office
Dpavia@PaviaRealEstate.com



Kevin Valenti
Licensed Associate Real Estate Broker
315.736.1555 x 303
kvalenti@PaviaRealEstate.com



5 Oxford Road
New Hartford, New York 13413

151 Northern Concourse
Syracuse, New York 13212

PaviaRealEstate.com
MAIN: 315.736.1555